

Cerama SC TOP-kilns



Cerama SC toppmatade ugnar

Cerama has been manufacturing kilns in Denmark since 1975 and with more than 35 years of experience in building kilns for both ceramics and glass, we have now developed a new top-loading kiln. Ceramas SC Kilns are the latest and most modern kiln model on the market.

New technology combined with high quality craftsmanship and know-how, makes these kilns unique with respect to firing economy, durability and finish. The usability is very broad and covers most needs from glass, porcelain painting, earthenware, stoneware and porcelain. The wide temperature range also contributes to the flexibility of the artistic work and is therefore an excellent choice for people working as glass or ceramic artists, teachers in schools and institutions or potters.

In addition to the kilns premier basic design, we also want to highlight the following properties:





Seamless insulating bricks.
-No deposition of loose mortar.



Multistick for easy connection
of controller.

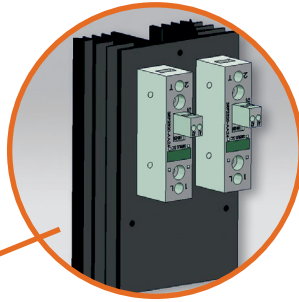

Silent Solid State relays controls
the heating elements in the kiln.
-Reduced wear on the heating elements.

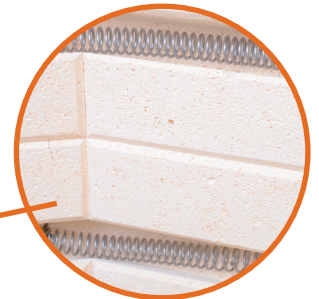

Professionally designed
heating elements.



Thermocouple in platinum,
well protected in kiln wall.

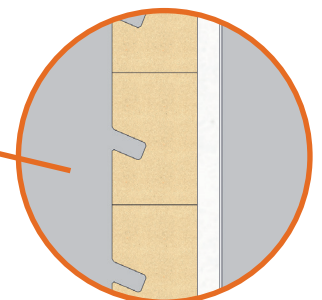

Kiln wall with effecient
two-layer insulation.

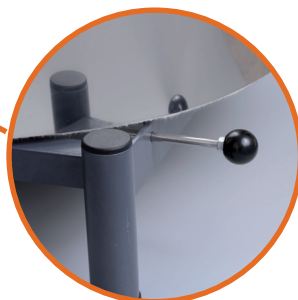

Ventilation hatch in the bottom
of the kiln.
Standard on all SC-kilns.



All Cerama top kilns in the SC-series are CE-marked and fulfill
the latest requirements and standards for function and safety.

Controller Cerama G20-20 ALL IN

G20-20 is the "Supreme choice" among controllers and, as the name G20-20 All In indicates, provides you with all the features you need regardless if you are working with glass or ceramics.

In spite that this controller is still user friendly and is pre programmed with 12 "ready to go" programs for both glass- and ceramic firings, all adapted after the most common types of firing cycle being used in the Nordic countries (see program list below). With a few simple steps you can start the firing and, if needed, any value can be changed during the firing i.e. if you want to change the top temperature or soak time.

The segments in G20-20 are programmed as follows: RATE(°C/h) – TEMPERATURE – TIME (soak)

For each segment time and temperature needs to be entered. For better differentiation the decimal point of the segment lights up when entering a time and the resulting shape of the current segment is shown on the upper right hand display as a dot matrix. For more information, see www.cebex.se



G20-20 ALL IN



G20-06

Automatik Cerama G20-06

This intelligent controller is perfect for controlling firing curves for i.e. earthenware, stoneware, porcelain and glass fusing.

With the G20-06, you can freely add 6 programs, each with 16 segments. Upon delivery, the G20-06, the first four program no are used for various applications such as (dehydration of a new furnace, biscuit firing, glaze firing 1020°C and glaze firing 1260°C).

Programs can be edited as desired. G20-06 also has an advanced monitoring system which react on any incident.

Comes with 1,4 m cable and CPC14 multiplug.

G20-06 is a standard controller for our new single phase kiln SC-20, read more about this on cebex.se.



Cerama SC TOP 20 - a new single phase top loader!

The new SC TOP-20 is manufactured with the same modern technology and craftsmanship as the larger kilns in this series.

SC-TOP 20 has a max temp. on 1300°C which opens up a wide usage area covering i.e. glass, earthenware, stoneware, porcelain etc.

Read more about this super-baby kiln on our web!



SC-TOP 20

Type	Volyme, L	Weight, kg	Power, kW	Fuse	Inner dim. (d,h)	Outer dim. (W;D;H)	Connection	Batt size	Controller
SC-20	20	50	2,2	10 A	Ø330x230	520x705x650	230V-J (1 fas)	Ø280x13	G20-06
SC-65	62	100	5,0	10 A	Ø400x490	610x775x870	3x400/N/J	Ø350x10	G20-20
SC-100	99	115	7,0	13 A	Ø470x570	680x850x870	3x400/N/J	Ø420x16	G20-20
SC-150	151	140	10,0	16 A	Ø580x570	780x975x870	3x400/N/J	Ø520x18	G20-20
SC-200	201	160	12,0	20 A	Ø670x570	910x1035x870	3x400/N/J	Ø620x18	G20-20

All measurements are in mm.

We reserve us the right to changes without further notice.